

LEGEND	
EXISTING ROAD	
EXISTING DRAIN	
EXISTING FENCE	
EXISTING BUILDING	
EXISTING VEGETATION	
EXISTING POWER	
EXISTING TELECOM	

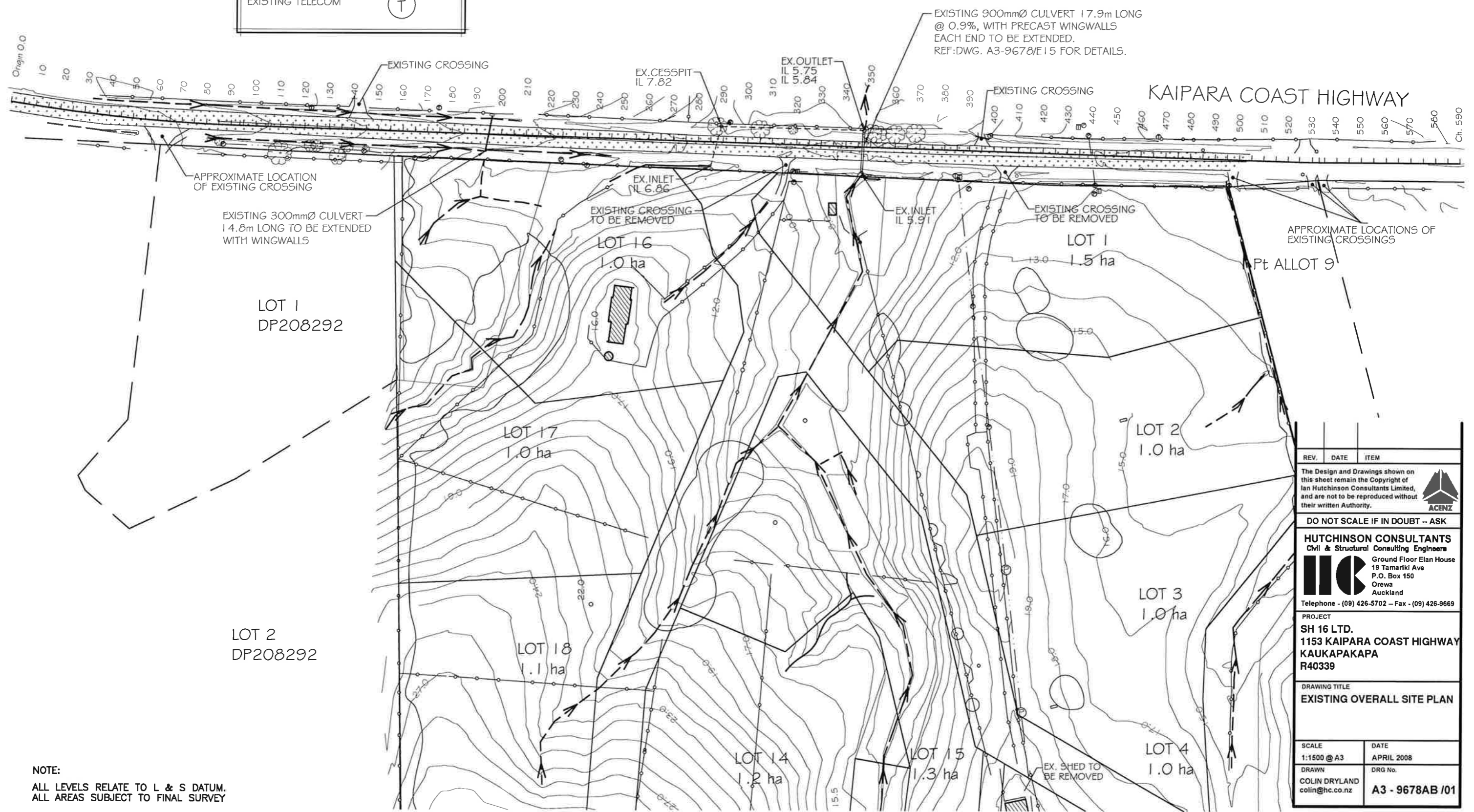

NOTE:
ALL LEVELS RELATE TO L & S DATUM.
ALL AREAS SUBJECT TO FINAL SURVEY

REV.	DATE	ITEM
<p>The Design and Drawings shown on this sheet remain the Copyright of Ian Hutchinson Consultants Limited, and are not to be reproduced without their written Authority.</p> <p>ACENZ</p>		
DO NOT SCALE IF IN DOUBT -- ASK		
<p>HUTCHINSON CONSULTANTS Civil & Structural Consulting Engineers Ground Floor Eian House 19 Tamaki Ave P.O. Box 150 Orewa Auckland Telephone - (09) 426-5702 - Fax - (09) 426-9669</p>		
<p>PROJECT SH 16 LTD. 1153 KAIPARA COAST HIGHWAY KAUKAPAKAPA R40339</p>		
<p>DRAWING TITLE EXISTING OVERALL SITE PLAN</p>		
SCALE	DATE	
1:1500 @ A3	APRIL 2008	
DRAWN	DRG No.	
COLIN DRYLAND colin@hc.co.nz	A3 - 9678AB /01	

LEGEND

- EXISTING ROAD
- EXISTING DRAIN
- EXISTING FENCE
- EXISTING BUILDING
- EXISTING VEGETATION
- EXISTING POWER
- EXISTING TELECOM

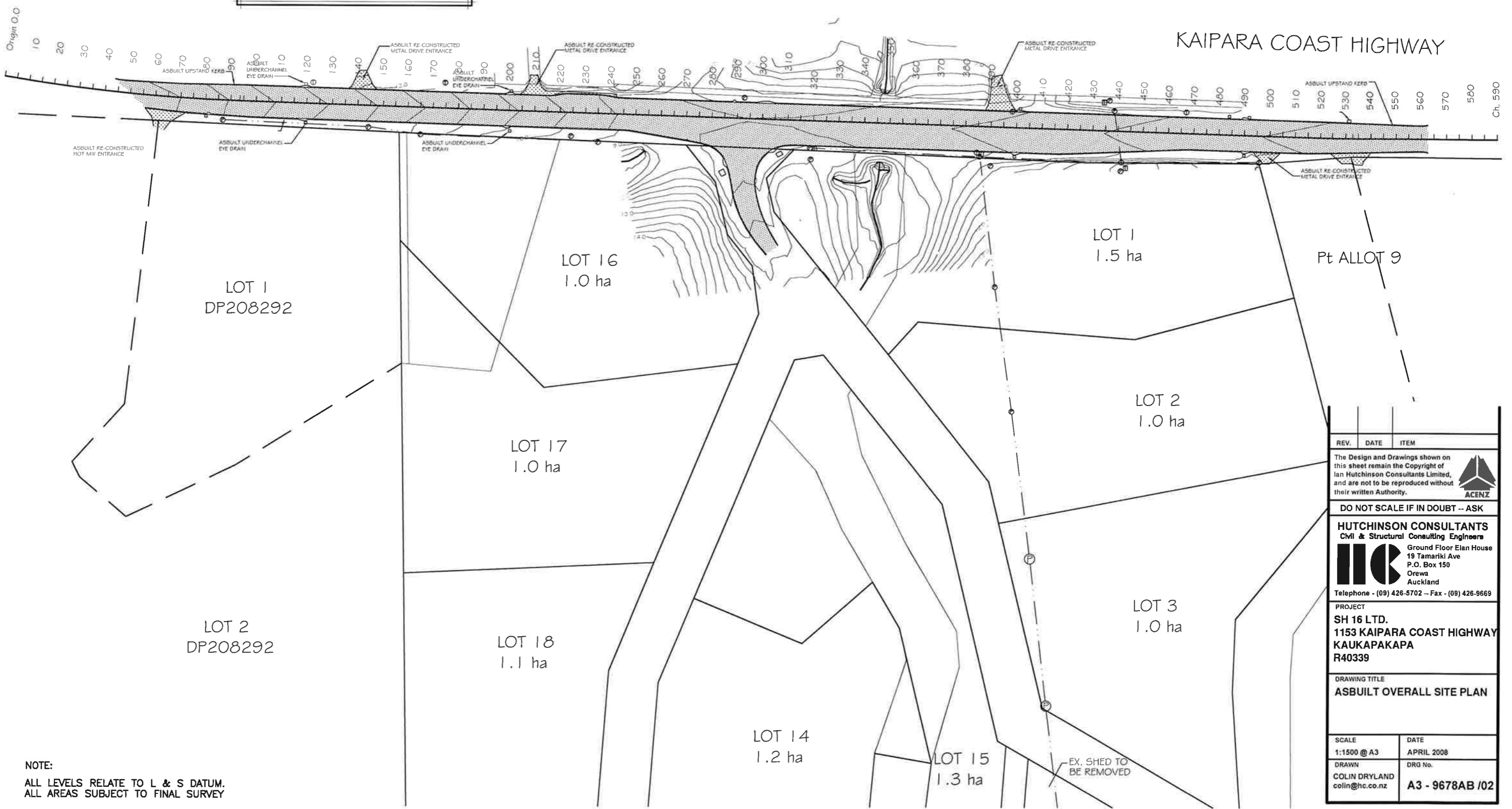

NOTE:
 ALL LEVELS RELATE TO L & S DATUM.
 ALL AREAS SUBJECT TO FINAL SURVEY

REV.	DATE	ITEM
<p>The Design and Drawings shown on this sheet remain the Copyright of Ian Hutchinson Consultants Limited, and are not to be reproduced without their written Authority.</p>		
<p>DO NOT SCALE IF IN DOUBT -- ASK</p>		
<p>HUTCHINSON CONSULTANTS Civil & Structural Consulting Engineers</p> <p>Ground Floor Eian House 19 Tamariki Ave P.O. Box 150 Orewa Auckland</p> <p>Telephone - (09) 426-5702 -- Fax - (09) 426-9669</p>		
<p>PROJECT SH 16 LTD. 1153 KAIPARA COAST HIGHWAY KAUKAPAKAPA R40339</p>		
<p>DRAWING TITLE ASBUILT OVERALL SITE PLAN</p>		
SCALE	DATE	
1:1500 @ A3	APRIL 2008	
DRAWN	DRG No.	
COLIN DRYLAND colin@hc.co.nz	A3 - 9678AB /02	

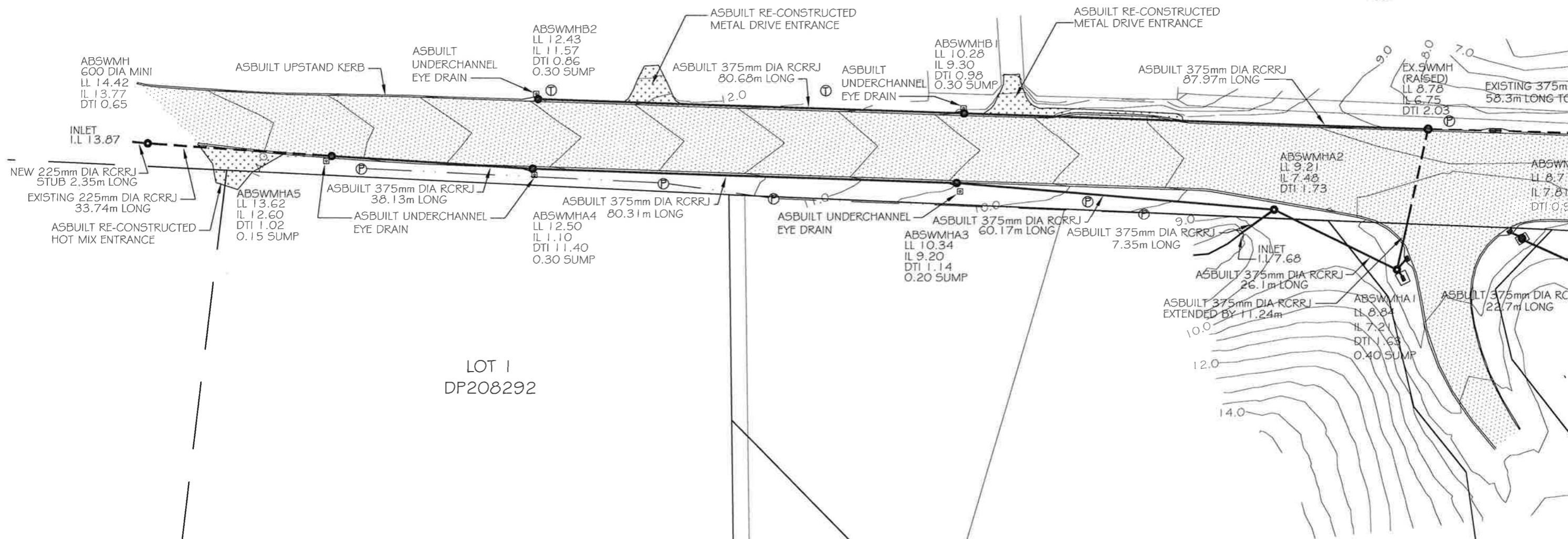

LOT 1
DP208292

LOT 2
DP208292

LEGEND	
EXISTING ROAD	
EXISTING DRAIN	
EXISTING FENCE	
EXISTING BUILDING	
EXISTING VEGETATION	
EXISTING POWER	
EXISTING TELECOM	

NOTE:
ALL LEVELS RELATE TO L & S DATUM.
ALL AREAS SUBJECT TO FINAL SURVEY

COMPLETE AS-BUILTS

SIGNED:

DATE:

REV.	DATE	ITEM
<p>The Design and Drawings shown on this sheet remain the Copyright of Ian Hutchinson Consultants Limited, and are not to be reproduced without their written Authority.</p>		
DO NOT SCALE IF IN DOUBT -- ASK		
<p>HUTCHINSON CONSULTANTS Civil & Structural Consulting Engineers</p> <p>Ground Floor Elan House 19 Tamariki Ave P.O. Box 150 Orewa Auckland Telephone - (09) 426-5702 - Fax - (09) 426-9669</p>		
<p>PROJECT SH 16 LTD. 1153 KAIPARA COAST HIGHWAY KAUKAPAKAPA R40339</p>		
<p>DRAWING TITLE PART STORMWATER AS-BUILT PLAN</p>		
SCALE	DATE	
1:1000 @ A3	APRIL 2008	
DRAWN	DRG No.	
COLIN DRYLAND colin@hc.co.nz	A3 - 9678AB /03	

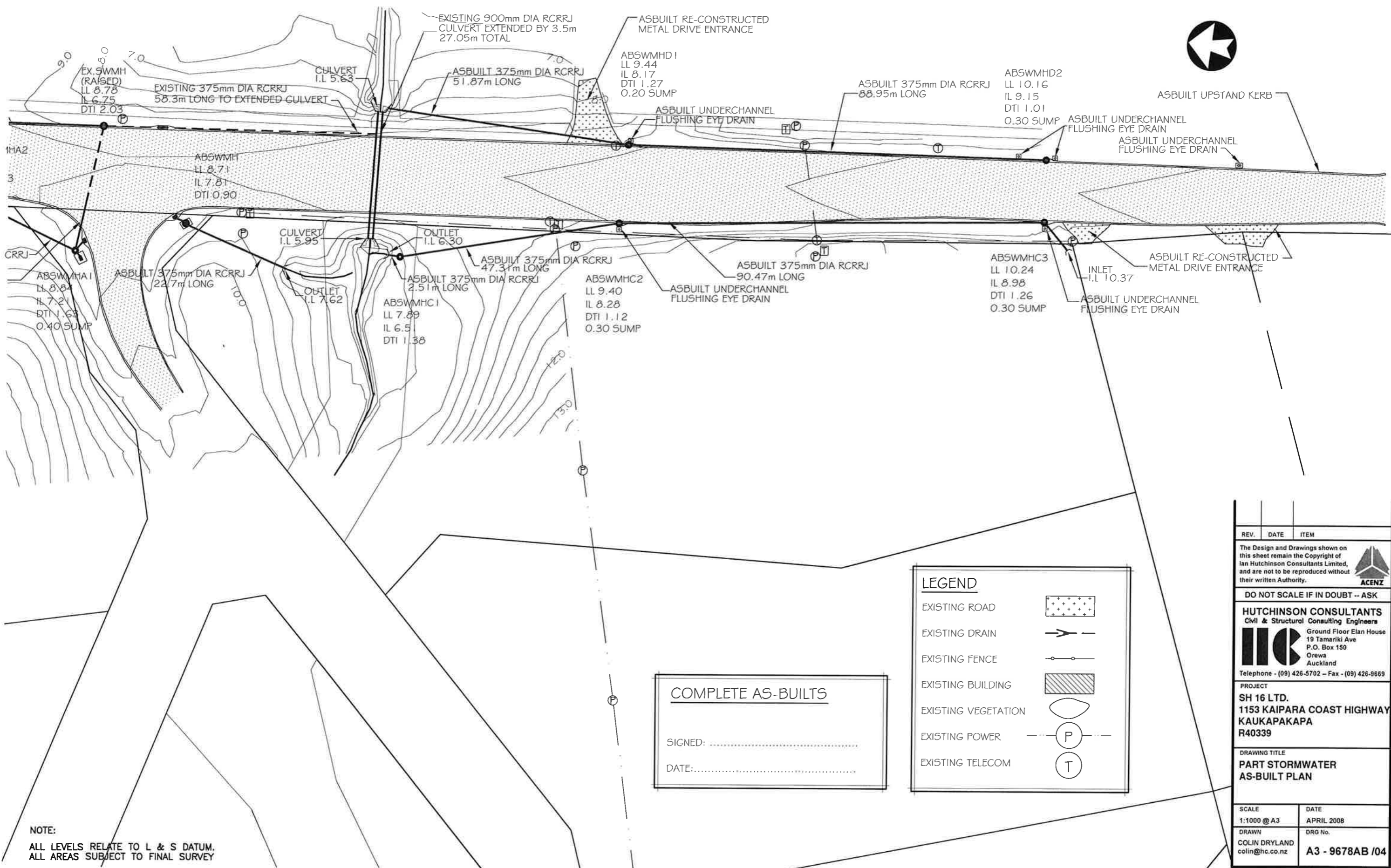

NOTE:
ALL LEVELS RELATE TO L & S DATUM.
ALL AREAS SUBJECT TO FINAL SURVEY

COMPLETE AS-BUILTS

SIGNED:

DATE:

LEGEND

- EXISTING ROAD
- EXISTING DRAIN
- EXISTING FENCE
- EXISTING BUILDING
- EXISTING VEGETATION
- EXISTING POWER
- EXISTING TELECOM

REV.	DATE	ITEM

The Design and Drawings shown on this sheet remain the Copyright of Ian Hutchinson Consultants Limited, and are not to be reproduced without their written Authority.

ACENZ

DO NOT SCALE IF IN DOUBT -- ASK

HUTCHINSON CONSULTANTS
Civil & Structural Consulting Engineers

HC Ground Floor Elan House
19 Tamaki Ave
P.O. Box 150
Orewa
Auckland

Telephone - (09) 426-5702 - Fax - (09) 426-9669

PROJECT
SH 16 LTD.
1153 KAIPARA COAST HIGHWAY
KAUKAPAKAPA
R40339

DRAWING TITLE
**PART STORMWATER
AS-BUILT PLAN**

SCALE 1:1000 @ A3	DATE APRIL 2008
DRAWN COLIN DRYLAND colin@hc.co.nz	DRG No. A3 - 9678AB /04